

**Wheel Estate Camper Rental, LLC**

10392 Melinda Dr. Clio, MI 48420

Cell (810)-938-RENT

**2015 Coachmen Clipper 17BH Trailer Rental Agreement**

Renter must be 25 years of age or older, debit card or credit card used for payment must be in Renter's name, Renter must have a valid driver's license, Renter must have full coverage auto insurance in their name and Renter must complete this Agreement and agree to all Wheel Estate Camper Rental, LLC Terms and Conditions attached below.

Last: \_\_\_\_\_ First: \_\_\_\_\_

Address: \_\_\_\_\_ City: \_\_\_\_\_ State: \_\_\_\_\_ Zip: \_\_\_\_\_

Home # ( ) \_\_\_\_\_ - \_\_\_\_\_ Mobile# ( ) \_\_\_\_\_ - \_\_\_\_\_ Driver's License#: \_\_\_\_\_

Email Address: \_\_\_\_\_ Previous renter? YES / NO (Circle one)

Rental Period Start Date:

\_\_\_\_/\_\_\_\_/\_\_\_\_

Rental Period End Date:

\_\_\_\_/\_\_\_\_/\_\_\_\_

Rental Location:

Campground: \_\_\_\_\_

Delivery Time – 3pm or later

Pick-up Time – Noon or before

Camp Site No.: \_\_\_\_\_

**Security Deposit:** A \$500.00 security deposit and remaining rental fee is required fourteen days (Date : \_\_\_\_\_) prior to the day of the Rental Period Start Date. This security deposit covers the cost in the event there are missing or damaged items inside or damages to the outside of the camping trailer during your stay. If necessary, additional costs associated with missing or damaged items inside or outside the camping trailer may be charged to your credit card that we have on file. The security deposit may also be used to pay any monies owed to Wheel Estate Camper Rental under this Agreement.

**Reservation:** A \$100 Non-refundable deposit is due at time of reservation.

**Rescheduling:** If you must cancel your reservation and you are within 30 days of the Rental Period Start Date, you may reschedule your reservation for a fee of \$50. You must notify Wheel Estate Camper Rental, LLC of your desire to reschedule and pay the \$50 rescheduling fee within 30 days of the Rental Period Start Date. The deposit that you placed toward your cancelled reservation will be applied to your rescheduled reservation. You have one year from the date you pay the \$50 rescheduling fee to reserve and occupy trailer from Wheel Estate Camper Rental, LLC or you will forfeit your deposited amount.

**Rental Amount:** The Rental price is (Daily Rental Rate \$ \_\_\_\_\_ x Nights(s) Rented \_\_\_\_\_) = \$ \_\_\_\_\_ + Deliver Charges (Miles:

\_\_\_\_\_ x \$1.75/Mile) = \$ \_\_\_\_\_ + Fridge (\$25) \_\_\_\_\_ + Table (\$5) \_\_\_\_\_ + \$500 Security Deposit= \$ \_\_\_\_\_

I would like to reserve/rent the trailer from Wheel Estate Camper Rental. I understand that Wheel Estate Camper Rental must approve the Agreement before a reservation can be confirmed. If approved, I authorize Wheel Estate Camper Rental to charge my credit card for reservation fee/rental amounts or any damages that I have caused during my rental period. I and Wheel Estate Camper Rental have the right to cancel the reservation under this Agreement. If I cancel my reservation more than 30 days prior to the Rental Period Start Date, I will not be charged. If I cancel the reservation less than 30 days prior to the Rental Period Start Date, the total deposit is non-refundable. If Wheel Estate Camper Rental cancels the reservation for any reason, all my payments made towards the rental will be refunded within 7 business days. The \$500 security deposit is refundable, except for deductions prescribed for in the Agreement and attached (Rental Terms and Conditions), within 7 business days after the Rental Period End Date if paid by credit card or cash, 21 days from the Rental Period End Date if paid by check.

Credit Card Number: \_\_\_\_\_ Expiration Date: \_\_\_\_\_ Security Code: \_\_\_\_\_

(Name on credit card must match name of Renter)

Print Name: \_\_\_\_\_ Sign: \_\_\_\_\_ Date: \_\_\_\_\_

(Signature acknowledges Renter has read and agrees with Wheel Estate Camper Rental, LLC Terms and conditions above)

Wheel Estate Camper Rental, LLC (Owner): \_\_\_\_\_ Date: \_\_\_\_\_

Receipt for deposit #: \_\_\_\_\_

**Wheel Estate Camper Rental, LLC**  
10392 Melinda Dr. Clio, MI 48420  
Cell (989)-938-RENT

**2015 Coachmen Clipper 17BH**  
**TERMS AND CONDITIONS**

**TO BE INTIALED AT RESERVATION AND SIGNED AT RENTAL PERIOD START-DATE**

1. **Definitions.** “Agreement” means all terms and conditions found in this form, any addenda and any additional materials we provide at the time of reservation/rental. “You” or “your” means the person identified as the renter on this form, any persons signing this Agreement, and any person or organization to whom charges are billed by us at its or the renter’s direction. All people’s referred to as “you” or “your” are jointly and severally bound by this Agreement. “We”, “our” or “us” means Wheel Estate Camper Rental. “Trailer” means the non-motorized camping trailer identified in this Agreement. “Loss of use” means the loss of our right to use the Trailer for any reason because of damage to it or loss of it during this rental. Loss of use is calculated by multiplying the number of days from the date of damage to the Trailer until it is repaired or replaced times the daily rental rate.

2. **Rental, Indemnity, and Warranties.** This is a contract for the temporary use of the Trailer at the Rental Location noted above. This contract does not provide you or any other party with the right to tow or otherwise move the Trailer from the Rental Location. Unauthorized movement of the Trailer will result in, at a minimum, a loss of the Security Deposit and, potentially, legal action. We may repossess the Trailer at your expense without notice to you if the Trailer is abandoned or used in violation of any applicable laws or this Agreement. *You agree to indemnify us, defend us and hold us harmless from all claims, liability, costs and attorney fees we incur resulting from, or arising out of, this rental and your use of the Trailer. We make no warranties, express, implied or apparent, regarding the Trailer, no warranty of merchantability and no warranty that the Trailer is fit for a particular purpose.*

3. **Campground Reservations.** We are not responsible for campground reservations. All campground reservations must be made separately with the campground’s reservation agency. All campground and campsite fees are separate from and in addition to the rental price and fees under this Agreement. No refunds will be given for campsite reservation errors.

4. **Check In.** Delivery times are generally between 1pm or later daily. It is your responsibility to call us at (810) 938-7368 on the Rental Period Start Date to check in with our office and receive your scheduled delivery time or pickup time. Delivery times will be scheduled on a first-come, first-serve basis.

5. **Delivery / Set up / Pick up.** For renters that wish to have the Trailer delivered we will deliver and set up the Trailer at the Rental Location on the Rental Period Start Date and pick up the Trailer upon completion of your Rental Period. At the time of delivery, one of our staff members will provide you with an orientation to show you the safe and proper use of the Trailer and its features. The Trailers will include instruction booklets which will explain the operation of the Trailer and its features. The orientation process can take up to one (2) hours - please allow yourself enough time. There are no refunds for early departures. The Trailer must be returned without damage and the inside must be clean prior to check out (dishes washed, dried, and put away, trash removed, floors swept, and countertops wiped). Failure to return without damage and/or in an unclean state will result in additional charges that may be deducted from the Security Deposit and, if necessary, additional charges may be made to your credit card.

6. **Valid Driver’s License.** An acceptable, valid driver’s license issued from your country of residence must be presented at the time of rental. The driver’s license must be valid for the entire rental period. If the driver’s license is in a language other than English, an International Driver’s Permit is recommended or other form of identification that we find acceptable.

7. **Acceptable Forms of Payment.** Payment for the rental may be made by cash, cashier’s check, debit card with either the Visa or MasterCard logo, or credit card with the Visa or MasterCard. If using a debit or credit card, you must present the card at the time of rental, along with a current driver’s license or other form of identification that we find acceptable. We will accept personal checks for the first half of payment only and as long as the reservation is made more than 30 days in advance. A \$50.00 fee will be charged for all returned checks.

**Initials** \_\_\_\_\_

8. **Prohibited Uses.** The following acts and/or uses are prohibited and constitute a breach of this Agreement subject, but not limited to, forfeiture of the security deposit, repossession of the Trailer without legal process, and/or legal action: a) the unauthorized towing, moving or other prohibited use of the Trailer; b) accessing or walking on the roof of the Trailer; and c) not complying with all campground rules and regulations, or State or federal laws.

9. **Personal Property.** You release us, our agents and employees from all claims for loss of, or damage to, your personal property or that of any other person, that was left or carried in or on the Trailer or in our offices, whether or not the loss or damages was caused by our negligence or was otherwise our responsibility.

10. **Personal Injury.** You release us, our agents and employees from all claims for injury, including, without limitation, personal, bodily, or mental injury, economic loss or damage to you, guests, unborn children, or relatives, whether or not the injury was caused by use of the Trailer, our negligence, or was otherwise our responsibility.

11. **Smoking.** There is **NO Smoking** in the Trailers. If the Trailer is returned with any kind of smoking odor, it will result in the forfeiture of the security deposit plus any additional charges incurred in cleaning and/or repair.

12. **Pet Policy.** NO pets are allowed in the trailer.

13. **Limited Supplies.** The Trailer comes equipped with approximately forty-five (45) gallons of fresh water, forty-five (45) gallons of grey and black water holding tank capacity, thirty (30) pounds of propane, and one (1) full charged 12 volt battery. It is your responsibility to ensure that these resources last your entire rental period. We will not provide customers additional water, holding tank capacity, propane, or battery during their rental period.

15. **Appliances.** The A/C, heat, awning, radio, microwave, television, jacks, etc. are convenience items. If any malfunctions should occur with any of these items, **no compensation** will be made to you. For assistance, you are advised to consult the informational material in the Trailer or contact Wheel Estate Camper Rental at (810)-938-7368.

16. **Renter Damage.** If the Trailer and/or the contents in the Trailer at the time of the delivery orientation are damaged during your rental period, you are responsible to pay all damage costs whether you were at fault or not or if damage was caused by acts of nature (wind, rain, earthquake, fire, flood, etc.). If an accident occurs, you are responsible for obtaining a police report, contacting the other party's insurance company and contacting us immediately at (810)-938-7368. At check-out, Wheel Estate Camper Rental will estimate the damage, if any, and expedite the cleaning and/or repair.

17. **Early Departures / Extending Rental Dates.** You are responsible for reviewing this Agreement to ensure that all rentals costs and rental dates are correct. If you wish to extend the rental period, you must call us for approval. There are **NO refunds** for early departures. If you do not vacate at the scheduled check-out time on the scheduled Rental Period End Date and you have not called us for approval to extend the rental period, you will be charged additional rental day(s), and any Inconvenience fees incurred by the next renter.

18. **Waiver.** Our failure to enforce any of our rights under this Agreement or at law shall not be deemed a waiver or a continuing waiver of any rights or remedies against another party, unless such waiver is in writing and signed by the party to be charged.

19. **Governing Law and Venue.** This Agreement shall be interpreted and enforced according to the substantive laws of the State of Michigan without application of its conflicts or choice of law rules. Both parties irrevocably submit to the jurisdiction of the state court located in Genesee County Michigan or the federal court for any action of proceeding regarding this Agreement, and both parties waive any right to object to the jurisdiction, forum or venue of the state court located in Genesee County Michigan or the federal court.

20. **Severability.** If any provision of this Agreement is judicially determined to be invalid, void or unenforceable, the remaining provisions shall remain in full force and effect.

21. **Attorneys' Fees.** In the event a dispute arises regarding this Agreement, the prevailing party shall be entitled to recover its reasonable attorneys' fees and costs, in addition to other relief to which it is entitled.

**Initials** \_\_\_\_\_

22. **Modifications.** No term of this Agreement can be waived or modified except by a writing that we have signed.

23. **Entire Agreement.** This Agreement constitutes the entire agreement between the parties regarding the rental of the Trailer, and supersedes all prior oral or written agreements or understandings regarding this subject matter. This Agreement can only be amended by a writing signed by all parties.

24. **Awning use:** You must be responsible while using the awning, during high winds and rain the awning must be retracted so not to be damaged. Any damage done to the awning will result in loss of security deposit to cover damages.

25. **Insurance:** If you are towing the Trailer you must provide us with valid insurance from your agent for your vehicle. Some insurance companies will cover damage to the Trailer under your policy as a towed vehicle.

26. **Refunds.** No refunds will be given for any reason, including, but not limited to, bad weather, no shows, late arrivals, or early departures.

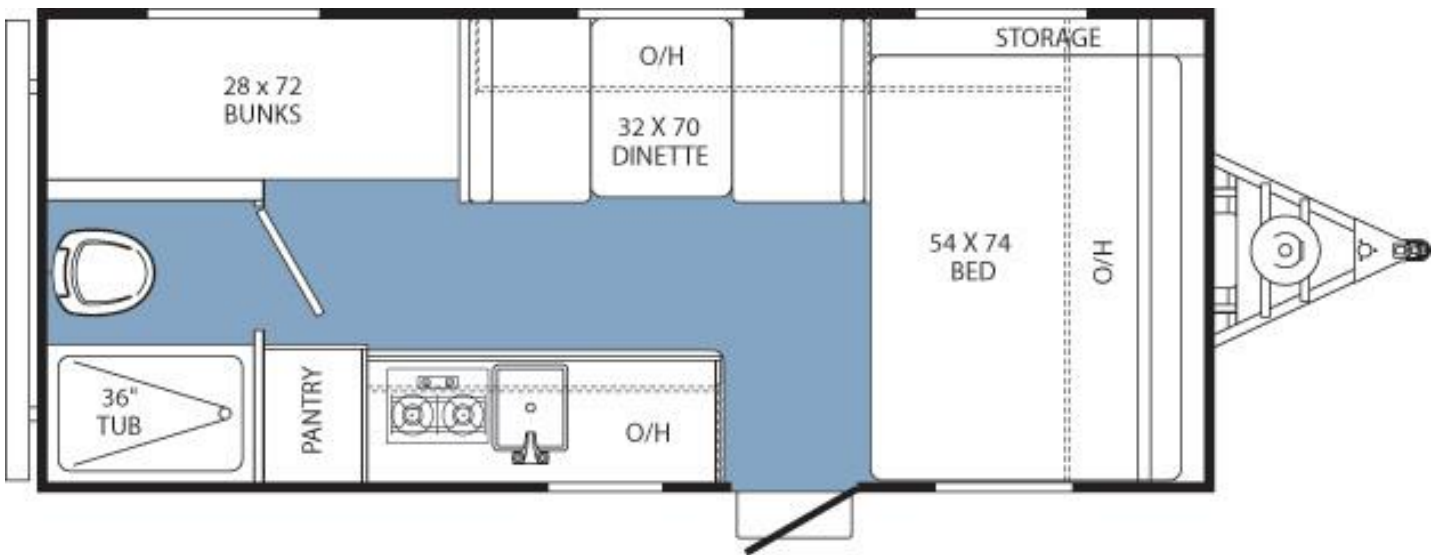

27. **Inspection:** Note any damage to the trailer at time of pickup or delivery on the layout above.

**Renter Initials:** \_\_\_\_\_ **Owner Initials:** \_\_\_\_\_

**Print Name:** \_\_\_\_\_ **Sign:** \_\_\_\_\_ **Date:** \_\_\_\_\_  
(Signature acknowledges that renter has read and agrees to the above Terms and Conditions)

**Wheel Estate Camper Rental, LLC (Owner):** \_\_\_\_\_ **Date:** \_\_\_\_\_

**Receipt for FULL rental payment #:** \_\_\_\_\_